



Transnet SOC Limited
Transnet RME

REQUEST FOR QUOTATION

BOARD LIST TFR RME
TRANSNET FREIGHT RAIL - RME
PROCUREMENT DEPARTMENT
2000

Registration Number: 1990/000900/30
Vat Number : 4720103177

Attention:

Telephone Number :
Fax Number :
Vendor Number :2004815

Quotation Deadline Date : 24.07.2015
Quotation Deadline Time : 16H00

REQUEST for QUOTATION

Transnet RME
RFQ Number / Date
6000229967 / 13.07.2015
Contact Person / Telephone
Uginthree Pillay / 0313611784
Return to FAX Number/EMAIL
0313800041 / TCPtendersDurban@Transnet.net

PREVIEW COPY ONLY

Item	Material	Description	RFQ Qty	UM	Required Del date	Confirm Del date	Unit Price Excl	Total Price Excl
00010		SUPPLY AND DELIVER REIN	130	ea	28.07.2015			

BEND, CUT AND SUPPLY REINFORCEMENT AS PER DRAWING
(AS PER BENDING SCHEDULE/BEND AND SUPPLY)

Transnet Limited t/a Transnet Freight Rail RME Durban, hereby invite your company to supply a separate detailed quotation to supply the following goods or services required:

SUPPLY AND DELIVERY REINFORCEMENT AS PER DRAWING /BENDING SCHEDULE. DELIVERED TO WASBANK, LADYSMITH.

All technical queries relating to this invitation may be addressed to: CONTACT PERSON: MPIOLO ZUNGU 07305636 315

All procurement relating queries can be addressed to:
Ms. Uginthree Pillay 031 3615107

The closing time for receipt of your official quotations is
16:00 hrs on FRIDAY 24TH JULY 2015

Telephonic and late quotes will not be accepted.



Transnet SOC Limited
 Transnet RME
 BOARD LIST TFR RME
 TRANSNET FREIGHT RAIL - RME
 PROCUREMENT DEPARTMENT
 2000
 YOUR VAT NUMBER WITH US: NOT

REQUEST FOR QUOTATION

Registration Number: 1990/000900/30
 Vat Number : 4720103177

Attention:
 Telephone Number :
 Fax Number :
 Vendor Number :2004815

Quotation Deadline Date : 24.07.2015
Quotation Deadline Time : 16H00

REQUEST for QUOTATION
 Transnet RME
RFQ Number / Date
 6000229967 / 16.07.2015
Contact Person / Telephone
 Uginthree Pillay / 0313611784
Return to V. X Number/EMAIL
 0313300071 / TCPtendersDurban@Transnet.net

Item	Material	Description	RFQ Qty	UoM	Required Del date	Confirm Del date	Unit Price Excl	Total Price Excl
------	----------	-------------	---------	-----	-------------------	------------------	-----------------	------------------

All quotations should be e-mailed to TCPtendersDurban@transnet.net OR Mduduzi.khoza@transnet.net.

The contractor's address and identification details have to be shown on each quotation received.

Please supply the following documents with every quotation submitted;

- # Valid Tax Clearance certificate.
- # Copy of your latest B.B.B.E.E. Certificate.
- # Certificate of good standing with the Workman's compensation commissioner.

Failing to submit any of the documents mentioned above, could result in your quotation to be disqualified / not accepted.

Note: Transnet may not necessarily accept the lowest or any other offer and reserves the right to select in its favor any or, a portion of any offer made

If you are unable to quote for this enquiry, please submit a NO QUOTE, with a short reason, if possible, for not being able to quote.

Otherwise we look forward to receive your quote by the date and time stated.

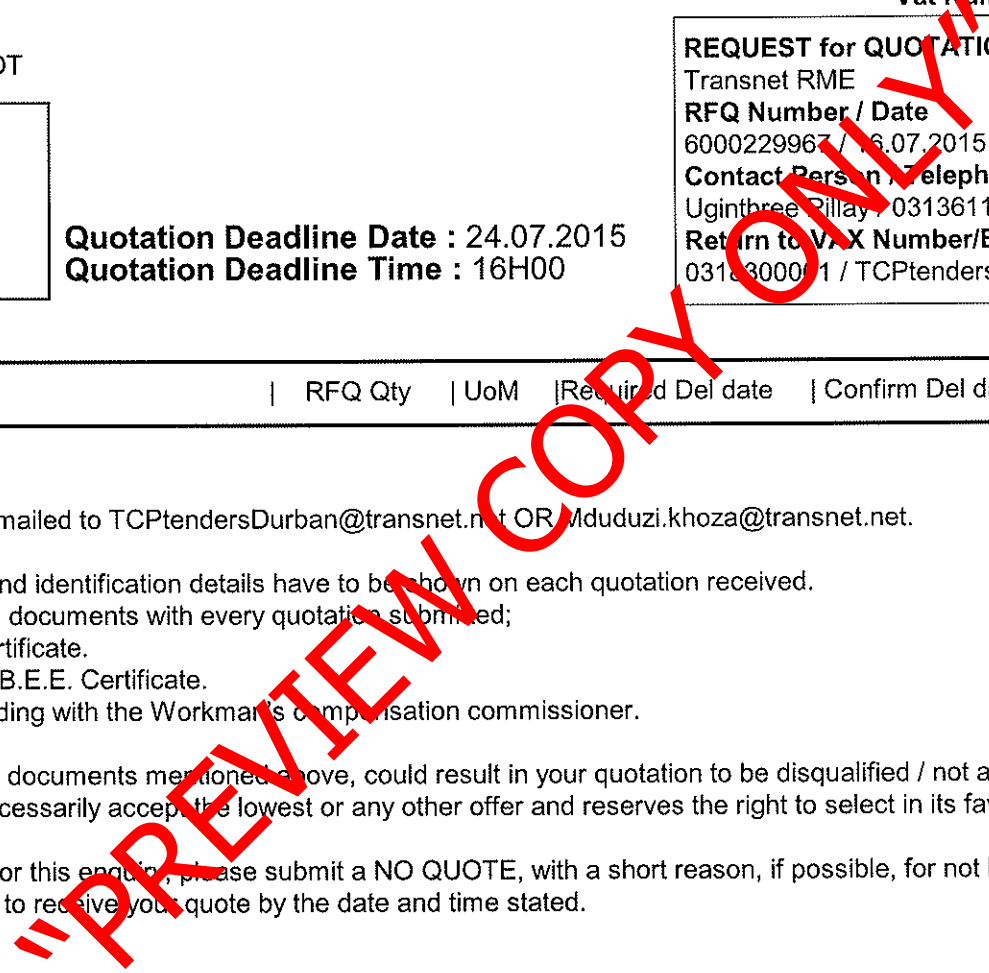



Transnet SOC Limited
 Transnet RME
 BOARD LIST TFR RME
 TRANSNET FREIGHT RAIL - RME
 PROCUREMENT DEPARTMENT
 2000
 YOUR VAT NUMBER WITH US: NOT

REQUEST FOR QUOTATION

Registration Number: 1990/000900/30
 Vat Number : 4720103177

Attention:
 Telephone Number :
 Fax Number :
 Vendor Number :2004815

Quotation Deadline Date : 24.07.2015
Quotation Deadline Time : 16H00

REQUEST for QUOTATION
 Transnet RME
RFQ Number / Date
 6000229967 / 16.07.2015
Contact Person / Telephone
 Uginthree Pillay / 0313611784
Return to FAX Number/EMAIL
 0313300011 / TCPtendersDurban@Transnet.net

Delivery Address
 TFR RME Durban
 100 Eel Road
 Bayhead, Durban
 4001

PRELIMINARY COPY

- This RFQ is subject to the following conditions:
1. Price/s : The price/s quoted in SA currency and is excluding of /,A.
 2. Delivery : The price/s quoted should include delivery cost to the delivery address stated on the RFQ
 3. Returnables : A valid tax clearance certificate and BBEE certificate from a SANAS accredited verification agency attached to quotation for all quotes above R30 000.
 Please note that only the official Transnet RFQ will be accepted and all other correspondence to be attached to the original
 4. Safety : To confirm to Transnet Freight Rail RME Health & Safety plan and specification; HAS-std-0001, copy available on request.
 5. Confirmation: To confirm your participation in this tender process please sign and return this document as immediate effect prior to the quotation deadline.
 6. Negotiations: The Employer may elect to negotiate the final terms of the contract/order with the preferred tenderer in accordance with Clauses F.2.17 and F.3.13 of the CIDB Standard Conditions of Tender. A copy of which is available upon request.
 7. Quotes will not be acceptable if not sending to the given fax or e-mail (please do not CC any buyer)
 8. Should your company not receive any response from Transnet within 30 days of closing of a RFQ, please accept that your quotation was unsuccessful.

Signature _____

Date _____

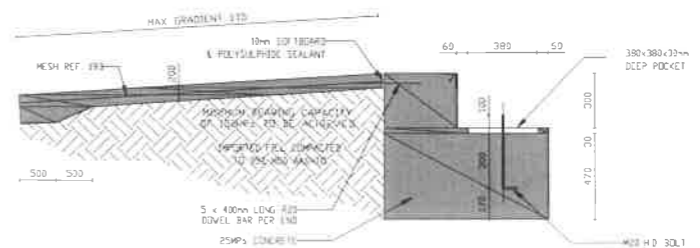
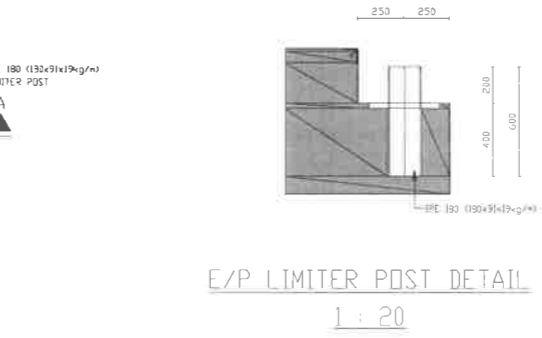
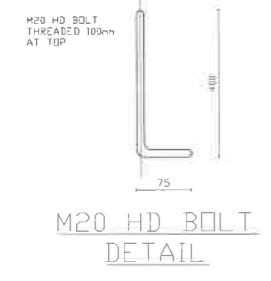
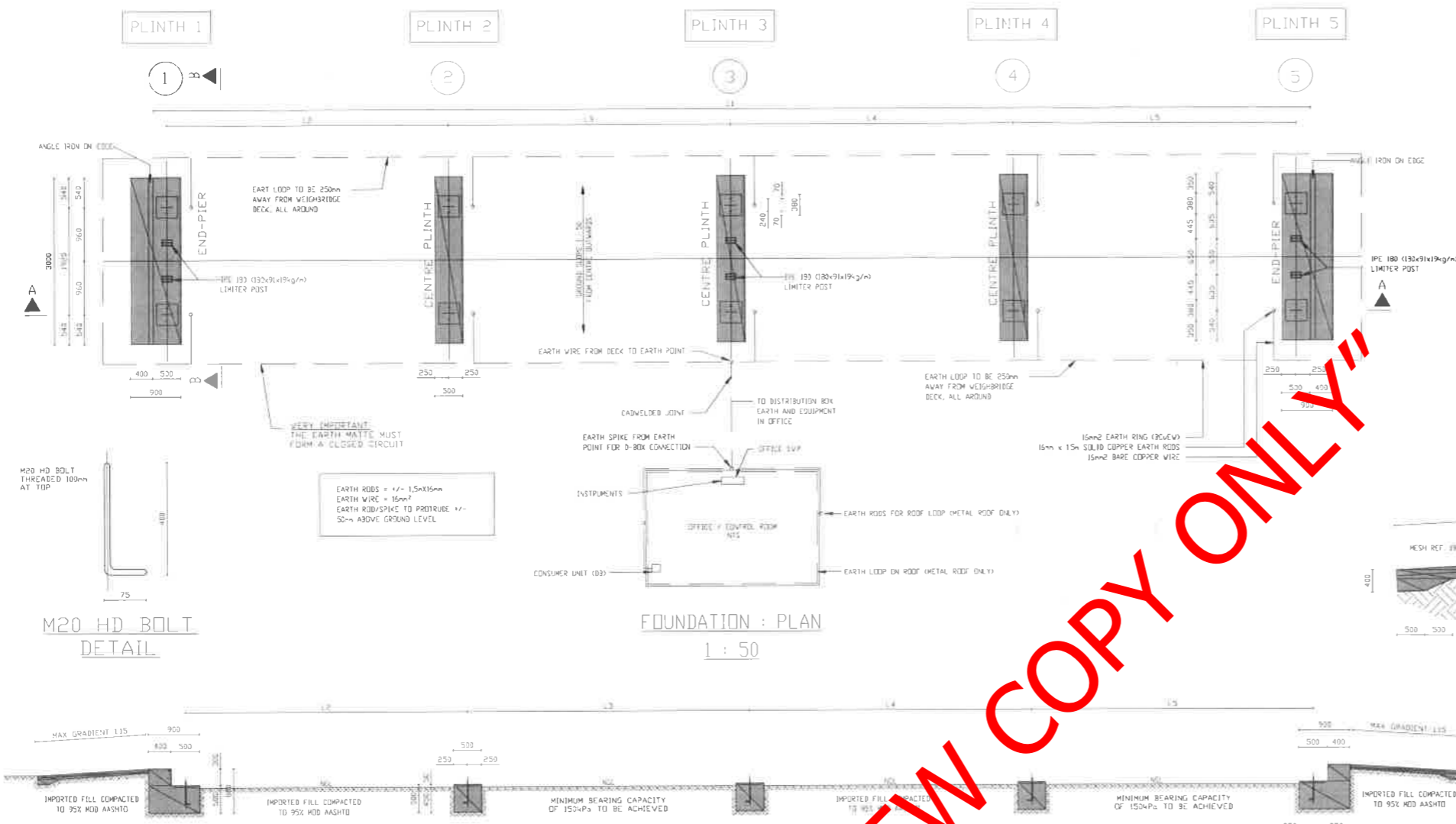

MEMBER	NO OF	MARK NO	DIA	NR IN ELK NO IN EACH	TOTAL	LENGTH	BENDING				
							A	B	C	D	E/F
END PIER											
1	1	01	112	19	22	2250	53	730	330		
2	2	02	112	18	28	2500	50	390	920		
3	2	03	112	3	6	4100	33	500	2900		
4	2	04	112	6	12	3700	33	400	2900		
5	2	05	112	4	8	3600	33	350	2900		
CENTRE PLINTH											
6	3	07	112	10	36	1800	60	330	430		
7	3	08	112	9	24	3700	33	400	2900		

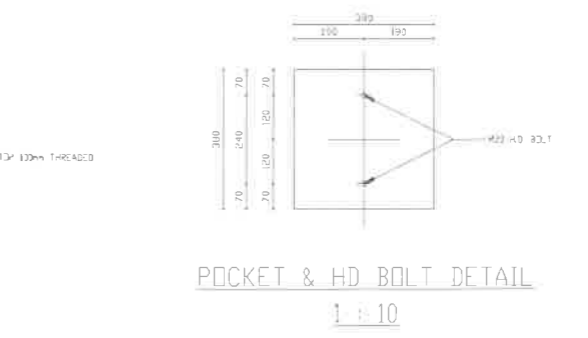
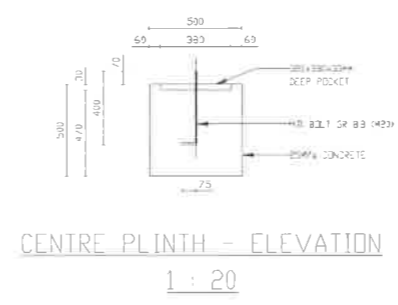
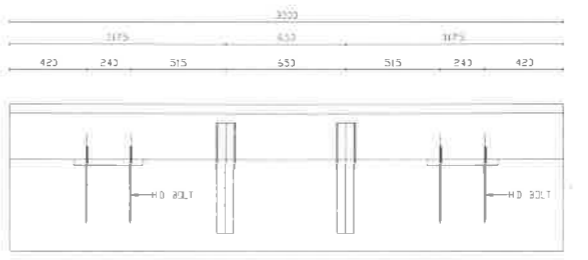
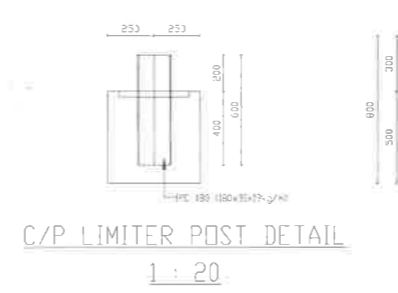

DISCLAIMER: BEHOLD - BEEN VERBODEN RE-PRODUCEREN OF DUBBIEZING DAAW/AN HAN GEWISSE SANCIE DIE WERPTOEGE TOEWIJZING VAN DIE MAATSKAPPIE. COPYRIGHT RESERVED - NO USE NOR REPRODUCTION NOR DUPLICATION THEREOF MAY OCCUR WITHOUT THE WRITTEN CONSENT OF THE COMPANY.

WYSIGINGS		AMENDMENTS	
No	DATE	DEUR BY	BESKRIVING

AFMETINGS		DIMENSIONS	
BRIDGE LENGTH	L1	L2	L3
22m	2200	5375	5375

AANTEKENINGE NOTES

- ALL DIMENSIONS ARE TO BE CHECKED AND CONTROLLED ON SITE BEFORE COMMENCEMENT OF CONSTRUCTION. ALL DISCREPANCIES MUST BE REPORTED TO KLERKSCALE IMMEDIATELY. NO CLAIMS THAT MAY ARISE DUE TO DIFFERENCES IN DIMENSIONS WILL BE GRANTED.
- KLERKSCALE WILL NOT BE RESPONSIBLE FOR THE SOLIDITY AND ACCURACY OF THE STRUCTURE OR THE STABILITY OF THE FOUNDING CONDITIONS.
- SETTING OUT TO BE FROM CENTER LINE OUTWARDS. ALL PLINTHS TO BE STRAIGHT, LEVEL AND BOLTS TO BE CAST INTO NO GROUTING OR TAPPING TO BE USED.
- FOUNDATIONS TO BE CONSTRUCTED ACCURATELY WITH A MAXIMUM OF 5mm TOLERANCE.
- BASES TO BE FOUNDED ON SOIL HAVING A SUITABLE BEARING PRESSURE AND P.I. WITH REINFORCEMENT AS PER DRAWINGS ISSUED AND IS THE RESPONSIBILITY OF CIVIL CONTRACTOR.
- THE WEIGHBRIDGE OFFICE MUST BE SO CONSTRUCTED THAT THE PERSON OPERATING THE INDICATING MECHANISM HAS A CLEAR AND UNOBSTRUCTED VIEW OF THE WHOLE PLATFORM.
- A STANDARD 3 POINT ELECTRICAL SOCKET (ISOLATED) TO BE PROVIDED IN THE OFFICE DELIVERING CLEAN 230 VAC WITH NOT MORE THAN 3 OHM BETWEEN EARTH AND NEUTRAL.
- ADEQUATE DRAINAGE IS ESSENTIAL BY MEANS OF NATURAL DRAINAGE.
- PVC CONDUITING 50mm BELOW THE SURFACE IS REQUIRED FROM THE CENTER OF THE FOUNDATION TO THE WEIGHBRIDGE OFFICE FOR THE LOAD CELL CABLE ONLY. THIS MUST NOT BE WITHIN 45mm OF ANY OTHER CABLE.
- ALL ELECTRICAL CONNECTIONS ARE THE RESPONSIBILITY OF THE CUSTOMER.
- INSTALLATION OF THE EARTH MATTE & CAST-IN ITEMS IS THE RESPONSIBILITY OF THOSE CONSTRUCTING THE WEIGHBRIDGE FOUNDATIONS.
- 25MPa CONCRETE TO BE UTILIZED FOR THE CONSTRUCTION OF THE CIVIL WORKS.



P.O. BOX 944
KLERKSDORP
2570

PHONE: +27 (18) 4691371
FAX: +27 (18) 4694112
EMAIL: info@klerkscale.co.za
WEB: www.klerkscale.co.za

AFDIK UITGEREIK OP PRINT ISSUED EN

KLIENT CLIENT
TRANSNET - HEIDELBERG

HANTWERKER SIGNATURE DATUM DATE

PROJEK PROJECT

FOUNDATION LAYOUT FOR
22m x 3m x 40 TON
ROAD WEIGHBRIDGE, FULL
ELECTRONIC, ABOVE SURFACE
300mm PROFILE, 4 SECTION

TEKENINGSTITEL DRAWING TITLE

FOUNDATION PLAN,
ELEVATIONS, DETAILS,
& BENDING SCHEDULE

SKAAL AS SHOWN SCALE

TEKENING NO DRAWING NO
2015K / 22 / 1

WYSIGINGS NO AMENDMENT NO