



Transnet SOC Limited
Transnet RME

REQUEST FOR QUOTATION

TRANSNET FREIGHT RAIL - RME
TFR RFQ BOARD-RME
PROCUREMENT DEPARTMENT
PORT ELIZABETH

Registration Number: 1990/000900/06
Vat Number : 4720103177

Attention:
Telephone Number :
Fax Number :
Vendor Number :500000

Quotation Deadline Date : 02.12.2013
Quotation Deadline Time : 16.00

REQUEST for QUOTATION
Transnet RME
RFQ Number / Date
6000182756 / 19.11.2013
Contact Person / Telephone
Yandiswa Oldjohn / 021 940 1911
Return to VAX Number/EMAIL
0218100000 / TCPTendersCapeTown@Transnet.net

Item	Material	Description	RFQ Qty	UoM	Required Del date	Confirm Del date	Unit Price Excl	Total Price Excl
00010		Convert 6 x toilets int	1	Ac	09.12.2013			

Convert 6 x toilets into showers as per attached Scope of Work & Bill of Quantities

REQUESTER AND DELIVERY ADDRESS:

AMANDA-TRANSNET FREIGHT RAIL

AMANDA - 041-5076024

DELIVERY: PORT OF PORT ELIZABETH

If you are unable to quote for this enquiry, please submit a NO QUOTE, with a short reason, if possible, for not being able to quote.

Otherwise we look forward to receive your quote by the date and time stated.

Transnet SOC Limited
 Transnet RME
 TRANSNET FREIGHT RAIL - RME
 TFR RFQ BOARD-RME
 PROCUREMENT DEPARTMENT
 PORT ELIZABETH
 6001

REQUEST FOR QUOTATION

Registration Number: 1990/000900/06
 Vat Number : 4720103177

**Attention:**

Telephone Number :
 Fax Number :
 Vendor Number :500000

Quotation Deadline Date : 02.12.2013
Quotation Deadline Time : 16.00

REQUEST for QUOTATION

Transnet RME
RFQ Number / Date
 6000182756 / 19.11.2013
Contact Person / Telephone
 Yandiswa Oldjohn / 021 940 1911
Return to VAX Number/EMAIL
 0218100000 / TCptendersCapeTown@Transnet.net

Item	Material	Description	RFQ Qty	UoM	Required Del date	Confirm Del date	Unit Price Excl	Total Price Excl
------	----------	-------------	---------	-----	-------------------	------------------	-----------------	------------------

The item covers the following services:

Delivery Address

TFR RME Cape Town
 De Gatt Complex, Behind Propne
 Bellville South, Cape Tow
 7530

This RFQ is subject to the following conditions:

1. Price/s : The price/s quoted in SA currency and is excluding of V.A.T
2. Delivery : The price/s quoted should include delivery cost to the delivery address stated on the RFQ
3. Returnables : A valid tax clearance certificate and BBBEE certificate from a SANAS accredited verification agency attached to quotation for all quotes above R30 000.
Please note that only the official Transnet RFQ will be accepted and all other correspondence to be attached to the original
4. Safety : To confirm to Transnet Capital Projects Health & Safety plan and specification; HAS-std-0001, copy available on request.
5. Confirmation: To confirm your participation in this tender process please sign and return this document as immediate effect prior to the quotation deadline.
6. Negotiations: The Employer may elect to negotiate the final terms of the contract/order with the preferred tenderer in accordance with Clauses F.2.17 and F.3.13 of the CIDB Standard Conditions of Tender. A copy of which is available upon request.

Signature _____

Date _____



Convert Shed 12 toilets to showers at break bulk

Item	Description	Unit	Quantity	Rate	Total Amount
1	CONTRACTUAL REQUIREMENTS				
1.1	Preliminary & General (Safety, supervision etc.)	wk	2		
2	WORKS				
2.1	Remove toilets, piping and toilet accessories	ea	6		
2.2	Install shower pipes and fittings	ea	6		
2.3	Brick up shower walls 2.1m high	ea	6		
2.4	Build a bum wall in shower	ea	6		
2.5	Install a pivot aluminium frame and glass shower door	ea	6		
2.6	Wall tiling	m2	63		
2.7	Floor tiling	m2	12		
2.8	Painting - provisional sum	sum	1		
2.9	Install hangers for clothes	No	18		
2.10	Supply and install 4.7kW heat pump	ea	1		
2.11	Supply and install 200Lt Frankie geyser	ea	2		
	Notes:				
o	All work should be in compliance with the SABS 1200				
o	All work should be complete and should a item not be itemised in detail it will be assumed that provision is made in your rates.				
o	Penalties of R 500/day for late completion - the completion will be agreed by client representative.				
o	As a operational area, complete occupation might not be available. STANDING TIME will not be accommodated.				
o	It is the responsibility of the service provider to check all quantities and conditions on site prior to submission of quotation.				



Convert Shed 12 toilets to showers at break bulk

SCOPE OF WORK:

Introduction:

The current ablution facility at Shed 12 has 11 toilets, but no showers. The purpose of this scope is to convert 6 of the 11 toilets to showers as indicated on the attached drawing.

Scope of work:

- 1) Remove the six toilets and toilet accessories as indicated on the drawing.
- 2) Do all the necessary piping for removing the toilets and installing showers in these six booths.
- 3) Tile the entire shower area and install a pivot aluminium frame glass shower door with a bun wall to prevent water from entering the rest of the facility.
- 4) Install at least 3 hangers for clothes in each booth. (no plastic fittings will be accepted)
- 5) Supply and install a heat pump system capable of producing enough hot water for 25 people to shower after they completed their shift.
- 6) Ensure that all areas where pipes have been installed or removed are sealed off neatly and painted.

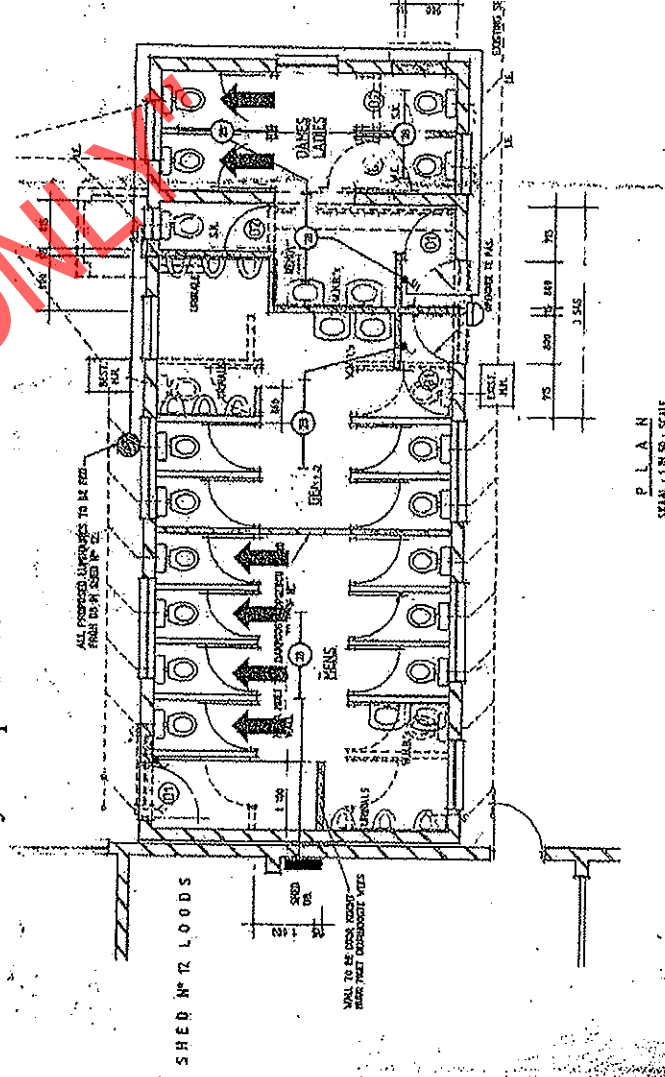

Safety related items:

- Prior to start of the work a comprehensive safety file needs to be submitted to the TPT RISK Manager for approval.
- If scaffolding is to be used, it must only be erected under the supervision of a certified person.
- As part of the safety file a comprehensive risk assessment and method statement must be included for approval.
- All related test and inspection certificates of all lifting equipment used must be submitted prior to the commencing of work activities.
- All artisans used must be qualified artisans – proof of qualifications to be included in safety file.
- Area of work activities must be suitably barricaded and sign posted to prevent unauthorized access.

Notes

- Time -line
- Will be determined on site meeting

GENERAL;

All steelwork to be corrosion protected.

The contractor shall supply all necessary tools, equipment and consumables.

The contractor will be responsible for all rigging gear needed to perform needed tasks.

All lifting gear and rigging equipment shall be safety certified.

All electrical tools shall be safety checked and certified on a regular basis.

All scaffolding shall be erected by qualified, certified, erectors and certified.

Contractor shall practice "good housekeeping" and leave the site clean and tidy.

All provisions and regulations of the Factory act shall be adhered to.