



**Transnet SOC Limited**  
**Transnet RME**

**REQUEST FOR QUOTATION**

TFR RME RFQ BOARD  
 TRANSNET FREIGHT RAIL RME  
 XXXXXXXXXXXXXXX  
 XXXXXXXXXXXXXXX

**Registration Number: 1990/000900/06**  
**Vat Number : 4720103177**

**Attention:**  
 TFR RME RFQ BOARD  
 Telephone Number :  
 Fax Number :  
 Vendor Number :500000

**Quotation Deadline Date : 15.11.2013**  
**Quotation Deadline Time : 16H00**

**REQUEST for QUOTATION**  
 Transnet RME  
**RFQ Number / Date**  
 6000180407 / 31.10.2013  
**Contact Person / Telephone**  
 Anne Mongie / 031 361 1759  
**Return to VAX Number/EMAIL**  
 0318300001 / TCPtendersDurban@Transnet.net

Item	Material	Description	RFQ Qty	UoM	Required Del date	Confirm Del date	Unit Price Excl	Total Price Excl
00010		STEELWORK FABRICATION 7	1	ea	25.11.2013			

STEELWORK FABRICATION 7 ITEMS  
 AS PER LIST ATTACHED MONTCLAIR  
 FOR MORE INFO PLEASE CONTACT MAHOMED : 083 278 9364

QUOTES MUST BE SENT TO : TCPtendersDurban@transnet.net OR :  
 FAXED TO 0318300001  
 CLOSING DATE 15 NOVEMBER 2013 AT 16H00.  
 PLEASE ATTACH COPIES OF BBBEE AND TAX CLEARANCE CERTIFICATES  
 ALL PROCUREMENT RELATED QUERIES TO BE DIRECTED TO :  
 ANNE MONGIE : 031 361 1759 E-MAIL : anne.mongie@transnet.net

IT IS COMPULSORY TO COMPLETE THE ATTACHED BILL OF QUANTITIES.  
 FAILURE TO DO SO WILL RESULT IN YOUR QUOTE BEING DISQUALIFIED.



## REQUEST FOR QUOTATION

Transnet SOC Limited  
 Transnet RME  
 TFR RME RFQ BOARD  
 TRANSNET FREIGHT RAIL RME  
 XXXXXXXXXXXXX  
 XXXXXXXXXXXXXXXXXXXX  
 0000

Registration Number: 1990/000900/06  
 Vat Number : 4720103177

**Attention:**  
 TFR RME RFQ BOARD  
 Telephone Number :  
 Fax Number :  
 Vendor Number :500000

**Quotation Deadline Date : 15.11.2013**  
**Quotation Deadline Time : 16H00**

## REQUEST for QUOTATION

Transnet RME

## RFQ Number / Date

6000180407 / 31.10.2013

## Contact Person / Telephone

Anne Mongie / 031 361 1759

## Return to VAX Number/EMAIL

0318300001 / TCPtendersDurban@Transnet.net

## Delivery Address

TFR RME Durban  
 100 Eel Road  
 Bayhead, Durban  
 4001

This RFQ is subject to the following conditions:

1. Price/s : The price/s quoted in SA currency and is excluding of V.A.T
2. Delivery : The price/s quoted should include delivery cost to the delivery address stated on the RFQ
3. Returnables : A valid tax clearance certificate and BBBEE certificate from a SANAS accredited verification agency attached to quotation for all quotes above R30 000.  
Please note that only the official Transnet RFQ will be accepted and all other correspondence to be attached to the original
4. Safety : To confirm to Transnet Capital Projects Health & Safety plan and specification; HAS-std-0001, copy available on request.
5. Confirmation: To confirm your participation in this tender process please sign and return this document as immediate effect prior to the quotation deadline.
6. Negotiations: The Employer may elect to negotiate the final terms of the contract/order with the preferred tenderer in accordance with Clauses F.2.17 and F.3.13 of the CIDB Standard Conditions of Tender. A copy of which is available upon request.

Signature \_\_\_\_\_

Date \_\_\_\_\_

ITEM	DRAWING	MATERIAL	QUANTITY	NOTES	SUPPLY	FABRICATE	COST EACH	TOTAL COST
1 KNEE BRACE	CEE-TMC-24	3CR12	30					
2 VERTICAL FOR S/ARM ATTACHMENT	CEE-TMF-105	3CR12	15	CHANNEL 6mm THICK				
3 STEADY ARM ATTACHMENT - 2.75m	TMFB - 124	3CR12	30					
4 KNEE BRACE ATTACHMENT FITTING	TMFB-169	3CR12	30					
5 BOOM ATTACHMENT FITTING	TMFB-170	3CR12	30					
6 Vertical S/Arm Attachments	TMFE - 6	3CR12	15					
7 CLAMPING ANGLE VERTICAL	TMHA-79	3CR12	30					
<b>TENDER TOTAL</b>								

**TENDER NOTES:**

1 All items to be priced supply and fabricate:

Supply refers to supply of raw material.

Fabricate refers to the complete fabrication process including transportation for collection and delivery, cutting and welding including all consumables required for the process.

2 Transnet reserves the right to supply all or portion of the materials required. Fabrication cost will be claimed in such cases.

3 Artisan qualification with welding codes to be submitted with tender.

4 Quality will be monitored by Transnet on an ongoing basis. Queries to be addressed with Mahomed Sayid 0832790438.

5 Quality control documents to be supplied on delivery.

ORIGINAL FRAME SIZE  
OORSPRONKLIKE RAAMGROOTTE 390 x 267

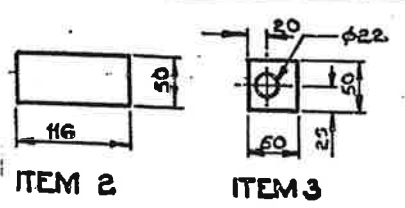

ITEM	DESCRIPTION ~ BESKRYWING	QTY. HVL.D.	STORES ITEM MAGASYNITEM NO.	DRAWING TEKZNING NO.	AMENDMENTS WYSIGINGS.		
					NO	NAME - NAAM	DATE - DATUM
1.	STEEL CHANNEL STAAL, KANAAL 76 x 38 x 6,9 kg/m x 2545L SPEC. CMES 5PES. SYM 8 OR COM. GRADE. SIM 8 OF HANDELSGRAAD	2	(M)11/4144				
2.	STEEL, FLAT STAAL, PLAT 50 x 10 x 116L SPEC. CMES 5PES. SYM 7 OR COM. GRADE. OF HANDELSGRAAD.	4	(M)11/12381		6	W.R. [Signature]	78-05-31
3.	STEEL, FLAT STAAL, PLAT 50 x 6 x 50L SPEC. CMES 5PES. SYM 7 OR COM. GRADE. OF HANDELSGRAAD.	4	(M)11/12279				
4.	STEEL CHANNEL STAAL, KANAAL 80 x 45 x 8,64 kg/m x 2545L SPEC. CMES 5PES. SYM 8 OR COM. GRADE. OF HANDELSGRAAD.	2					

REDRAWN. TITLE CHANGED.  
ITEM 4 ADDED. ASSY. DRG.  
NO. CEE-TMG-61 ADDED  
OORGETEKEN. TITEL VERAN-  
DER. ITEM 4 BYGEVOEG.  
SAMESTEL. TEK. NO.  
CEE-TMG-61 BYGEVOEG  
D.O. REF. Y76/43.  
TK-VERW.

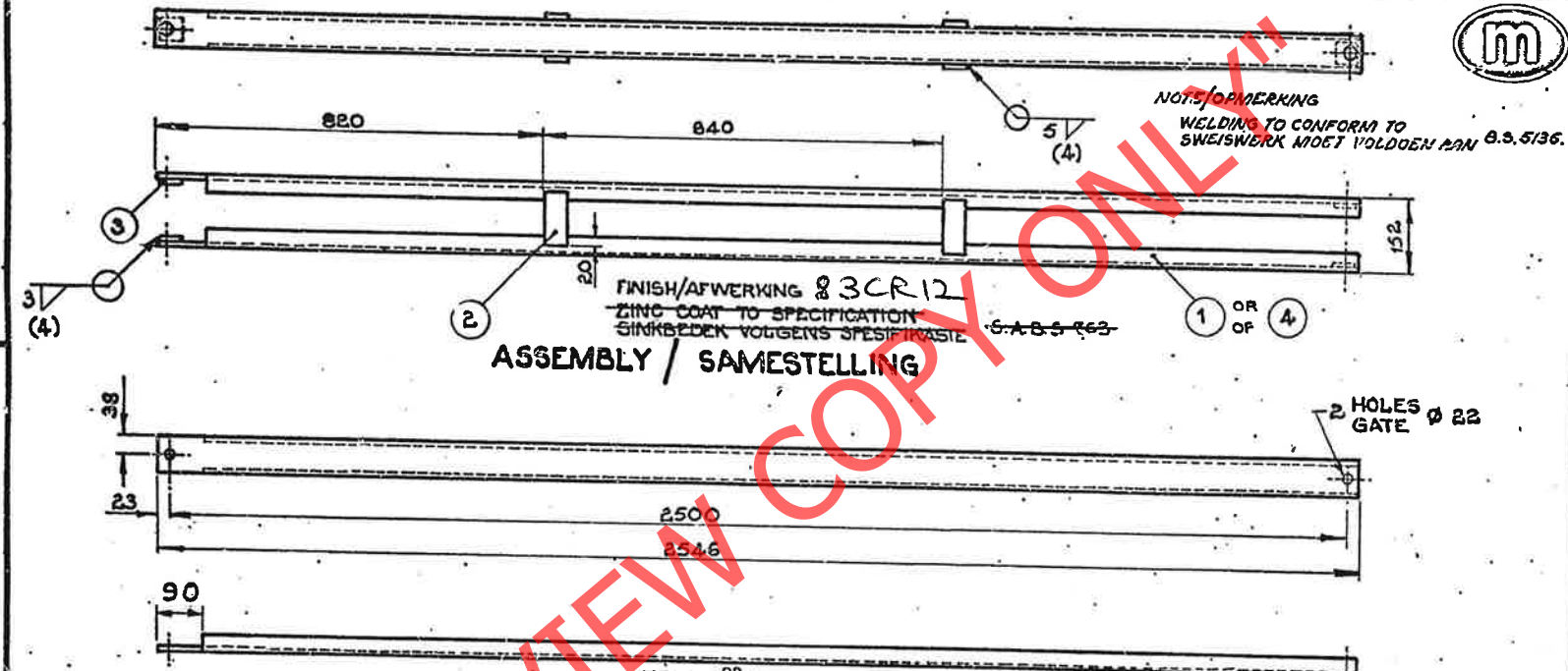

ASSEMBLY / SAMESTELLING

GEN. TOLERANCES / ALG. TOLERANSIES

LEN.	0 - 50	51 - 100	101 - 250	251 - 500	501 - 1000
	±0.15	±0.20	±0.30	±0.40	±0.50

DIMENSIONS: MILLIMETRES.  
AFMETINGS: MILLIMETER.

DRN. GET.	Y.V.D.W.	GEN. TOLERANCES: P.LIN. ALG. TOLERANSIES: ANG./HOEK (AANGETOOK)	ENG. IR.	D.B.
TRCD. NGT.		D.O. REF. TK-VERW. C/78/2/66	DATE. DATUM.	2-5-66
CKD. NGS.	F.W.C.	CHIEF ELECTRICAL ENGINEER S.A.R. JOHANNESBURG. ELEKTROTEGNIËSE HOOFINGENIEUR. S.A.S.		

**KNEE BRACE FOR ALL STRAIGHT BOOMS.**  
229 x 178 & 203 x 152 I-MASTS.  
203 x 203 UNIVERSAL COLUMNS.

**KNIESPANSTUK VIR ALLE REGUITDWARSBALKE.**  
229 x 178 & 203 x 152 I-MASTE.  
203 x 203 UNIVERSELE KOLOMME.

7.	B. Stewart	81-05-18
CUT-OUT INCREASED FROM 90 TO 130 AND 230. UITSNYDING VERGROOT VAN 90 NA 130 EN 230. DO. REF. T1/80/15. TK-VERW.		
8.	B. Stewart	81-06-09
CUT-OUT CHANGED BACK TO 90. UITSNYDING TERUG NA 90. VERANDER. DO. REF. T1/81/29. TK-VERW.		

CEE TMG 61  
CEE TMG 51  
CEE TMG 40  
CLASS-ASSY DRG.  
KLAS-SAMESTEL-TEK.  
DRAWING TEKENING NO. **CEE**  
**TMC-24**

A3  
A4

3

4

4



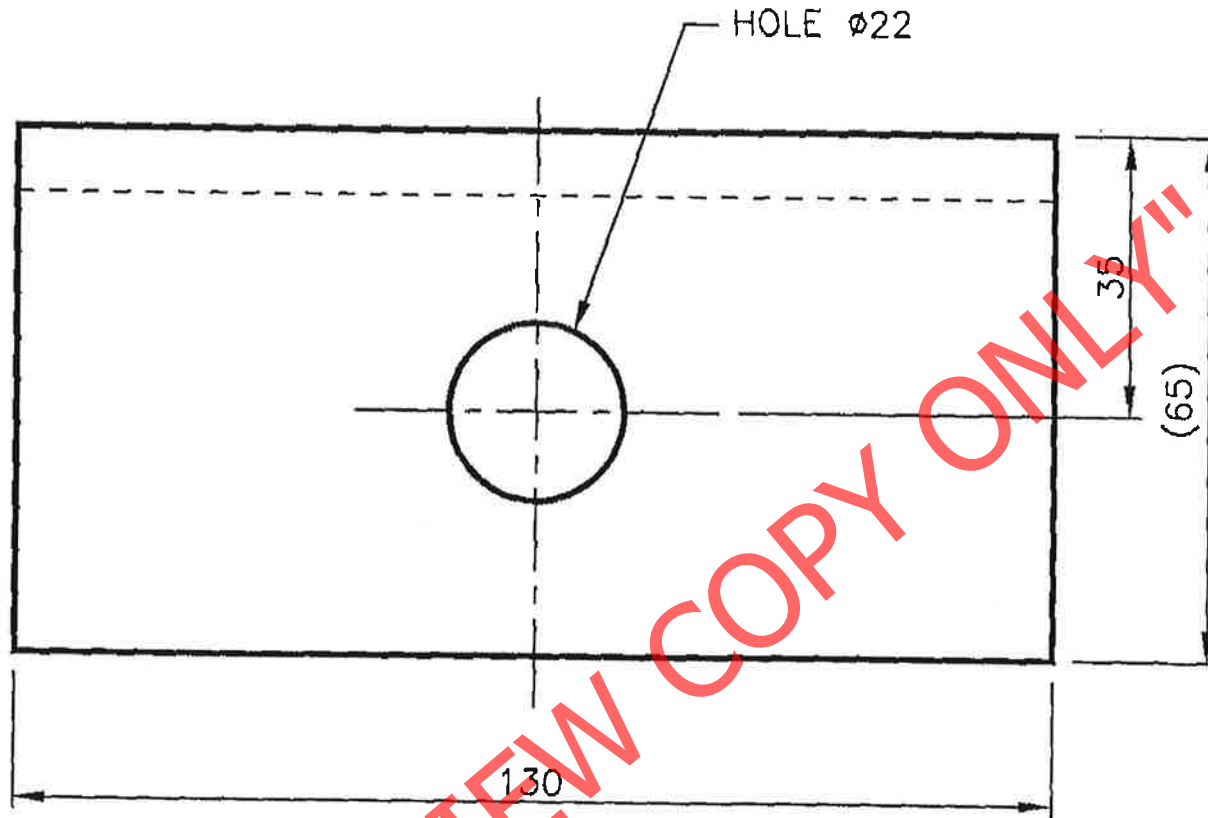

AMENDMENTS		
NO	NAME	DATE
1	J v DYK	2000-10-30
REDRAWN. DRG NO WAS CEE-TMHA-77. DO REF T95/067		

MATERIAL: ITEM NO 11/14582. STEEL, ANGLE 65 x 50 x 8 TO SPEC GME 9 SYM 8 OR COMMERCIAL GRADE.

DO REF: —	GEN TOL: LIN± 1	ANG± -
DRN: F W C	CKD: J F S	DATE: 63-06-03
ENG: J P	T C BROOK for CHIEF ENG	

BRACKET: KNEE BRACE  
ATTACHMENT

I-MASTS 203 x 152 & 229 x 178  
UC MASTS 203 x 203

INFRASTRUCTURE  
(ELECTRICAL)



3CR12

DIMENSIONS: mm  
SCALE: 1:1



DRG NO CEE-  
TMFB-186

SHT — OF —

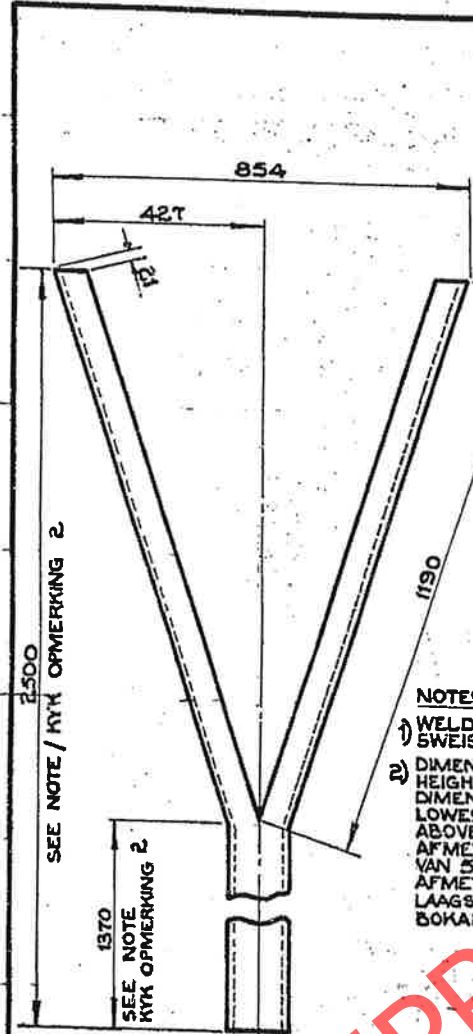

ITEM	DESCRIPTION ~ BESKRYWING	QTY. HVL D.	STORES ITEM MAGASYNITEM NO.	DRG. NO. CEE TEK.	AMENDMENTS. WYSIGINGS.	
					NO.	NAME. NAAM.
1	STEEL, CHANNEL 127x64 x 14, 89 kg/m x 2560L SPEC. CME 9 SYM. 8 STAAL, KANAAL	1	(M)11/1382	---		
2	STEEL, FLAT 80 x 12 x 250L SPEC. CME 9 SYM. 7 STAAL, PLAT	2	(M)11/2522	---	9	W.R.G.
3	STEEL, FLAT 40 x 10 x 400L SPEC. CME 9 SYM. 7 STAAL, PLAT	1	(M)11/2368	---		
4	STEEL, CHANNEL 140x60 x 16 KG/M x 260L SPEC. CME 9 SYM. 8 STAAL, KANAAL	1	(M)11/1471	---		

NO.	NAME. NAAM.	DATE. DATUM.
9	W.R.G.	78-02-16
10		85-08-13

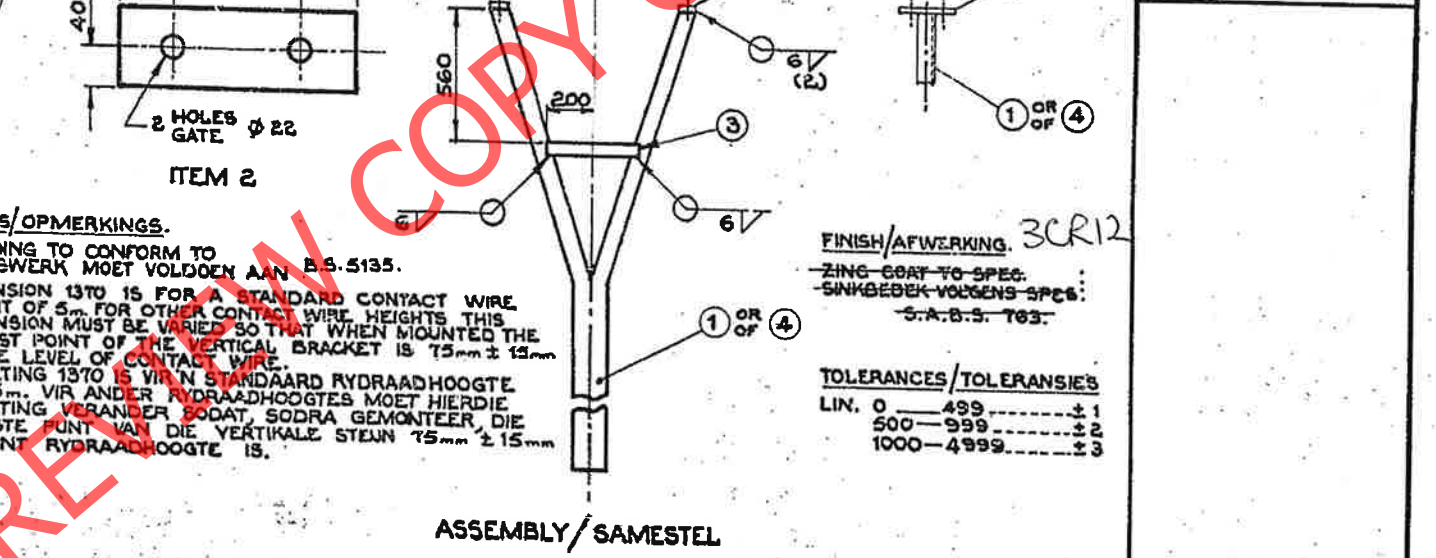

**NOTES/OPMERKINGS.**

1) WELDING TO CONFORM TO SWEISWERK MOET VOLDOEN AAN B.S. 5135.

2) DIMENSION 1370 IS FOR A STANDARD CONTACT WIRE HEIGHT OF 5m. FOR OTHER CONTACT WIRE HEIGHTS THIS DIMENSION MUST BE VARIED SO THAT WHEN MOUNTED THE LOWEST POINT OF THE VERTICAL BRACKET IS 75mm ± 15mm ABOVE LEVEL OF CONTACT WIRE.

AFMETING 1370 IS VIR 'N STANDAARD RYDRAADHOOGTE VAN 5m. VIR ANDER RYDRAADHOOGTES MOET HIERDIE AFMETING VERANDER SODAT, SODRA GEMONTEER, DIE LAAGSTE PUNT VAN DIE VERTIKALE STEUN 75mm ± 15mm BOKANT RYDRAADHOOGTE IS.

**FINISH/AFWERKING.** 3CR12

ZINC-COAT TO SPEC. SINKBEDEK VOLGENS SPES. S.A.S.S. 783.

**TOLERANCES/TOLERANSIES**

LIN. 0 - 499 ..... ± 1  
 500 - 999 ..... ± 2  
 1000 - 4999 ..... ± 3

DIMENSIONS: MILLIMETRES. AFMETINGS: MILLIMETER.		S.A. TRANSPORT SERVICES VERVOERDIENSTE	
DRN. GET. K.V.V.	GEN. TOLERANCES: LIN. NOTED/ANGETOON ALG. TOLERANSIES: ANG./HOEK.	ENG. IR. J.G.G.N.	
TRCD. NGT. J. HIBBERS.	D.O. REF. TK-VERW.	P. MURRAY for	
CHK. NGS. H.N.	DATE. DATUM. 18:1:65		
CHIEF ELECTRICAL ENGINEER. ELEKTRIESE HOOFINGENIEUR		JOHANNESBURG.	

**VERTICAL BRACKET FOR STEADY ARM ATTACHMENT. DOUBLE BOOM AND LATTICE BRIDGE STRUCTURES AND TWO TRACK CANTLEVERS.**

**VERTIKALE STEUN VIR SLINGERINGSARMHEGSTUK. DUBBELDMARSBALK EN TRALIEBRUGSTRUKTURE EN TWESPOORVRYDRAERS.**

CEE-TMF-166  
 CEE - TMF - 106  
 CEE - TMF - 107  
 ASSY. DRG./SAMEST-TEK.  
 DRAWING. TEKENING. NO. CEE  
**TMF-105**



ITEM	DESCRIPTION	QTY	STORES ITEM NO	DRG NO CEE--	AMENDMENTS		
1	CLAMPING BRACKET	1	_____	TMFB-138	NO	NAME	DATE
2	STEEL, ANGLE, 70 x 70 x 6 x "A" LG	1	_____	_____	1	J DU PLESSIS	94-08-17
3	STEEL, FLAT, 50 x 10 x 50 LG	1	_____	_____			

DETAILS OF USE	DIMENSION "A"
2,75m MAST $\odot$ - TRACK $\odot$	1000
3,2m MAST $\odot$ - TRACK $\odot$	1450
3,7m MAST $\odot$ - TRACK $\odot$	1950
WITH HOCKEY STICK	600

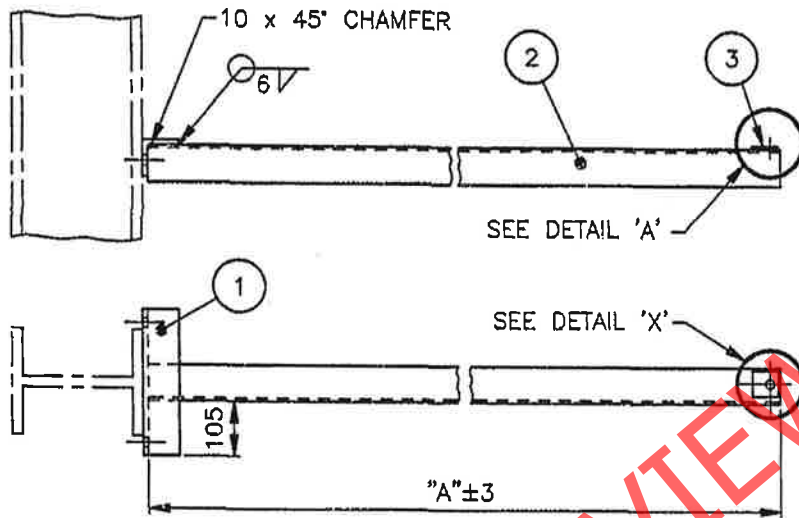

FINISH: SCR 12  
~~ZINC COAT TO SPEC SABS 783~~  
~~FOR CONDITIONS IN SITU.~~

- NOTES
1. WELDING TO CONFORM TO SPEC BS 5153.
  2. FOR STEADY ARM ATTACHMENT EXTENSION BRACKET FOR NON-STANDARD MAST-TO-TRACK CENTRES SEE DRG NO CEE-TMFB-123.

DRILL HOLE  $\phi$ 18 AFTER WELDING

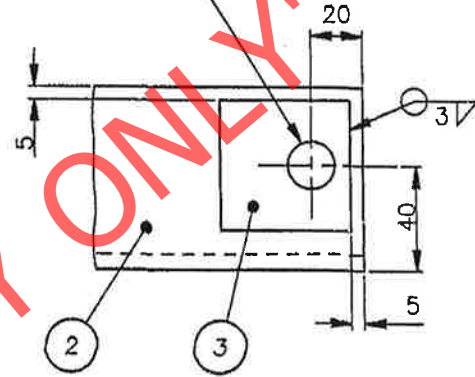

DETAIL 'X'  
SCALE 1:2

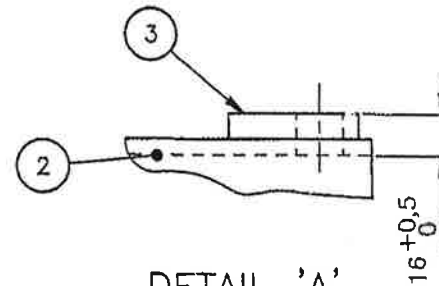

DETAIL 'A'  
SCALE 1:2

DRG REVISED.  
 DRG NO WAS CEE-  
 TMF-208.  
 NOTE 2 ADDED.  
 DO REF: T94/040.

DO REF: Y76/43	GEN TOL: LIN $\pm$ 1	ANG $\pm$ 2'
DRN: J HIBBERS	CKD: WRG	DATE: 78-03-31
ENG: I DE VILLIERS	F PIENAAR	for CHIEF ENG

INFRASTRUCTURE  
(ELECTRICAL)

STEADY ARM AND HOCKEY STICK ATTACHMENT  
 203 x 203 UNIVERSAL COLUMNS.

STORES ITEM NO

DIMENSIONS: mm  
 SCALE: 1:10



DRAWING NO CEE-  
 TMFB-124

SHEET — OF —

10000533

ITEM	DESCRIPTION	QTY	STORES ITEM NO	DRG NO CEE-	AMENDMENTS		
1	BRACKET, KNEE BRACE ATTACHMENT	2	—————	TMFB-186	NO	NAME	DATE
2	CLAMPING BRACKET	2	—————	TMFB-138	1	J v DYK	2000-10-30

REDRAWN. DRG NO WAS CEE-TMF-203. DO REF T95/067

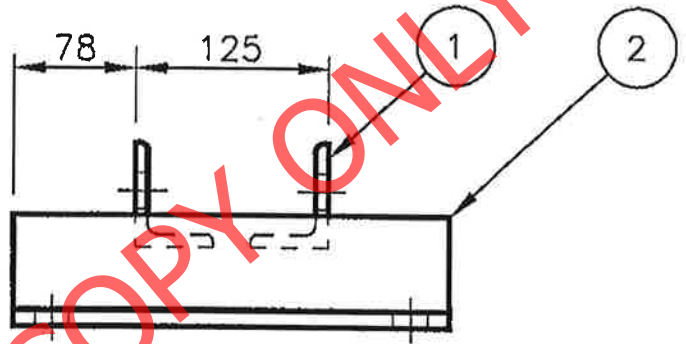
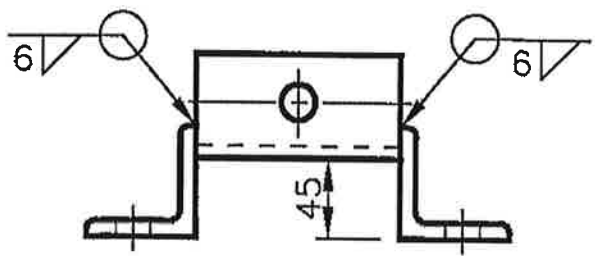

"PREVIEW COPY ONLY"

NOTE  
WELDING TO CONFORM TO SPEC. B.S. 5135  
FINISH : 3CR12  
ZINC COAT TO SPEC. SABS 763 FOR CONDITIONS IN SITU

DIMENSIONS: mm  
SCALE: 1:5

DO REF: Y76/43	GEN TOL: LIN± 1 ANG± -
DRN: B v RENSBERG	CKD: W R G DATE: 78-03-31
ENG: J de VILLIERS	F PIENAAR for CHIEF ENG

## ATTACHMENT-KNEE BRACE

203 x 203 UNIVERSAL COLUMNS



DRG NO **CEE-**  
**TMFB-169**

INFRASTRUCTURE  
(ELECTRICAL)



SHT — OF —



ITEM	DESCRIPTION	QTY	STORES ITEM NO	DRG NO CEE-	AMENDMENTS		
1	CLAMPING BRACKET	2	_____	TMFB-138	NO	NAME	DATE
2	BRACKET, BOOM ATTACHMENT	2	_____	TMHA-78	1	J v DYK	2000-10-30

REDRAWN. DRG NO WAS CEE-TMF-205. DO REF T95/067

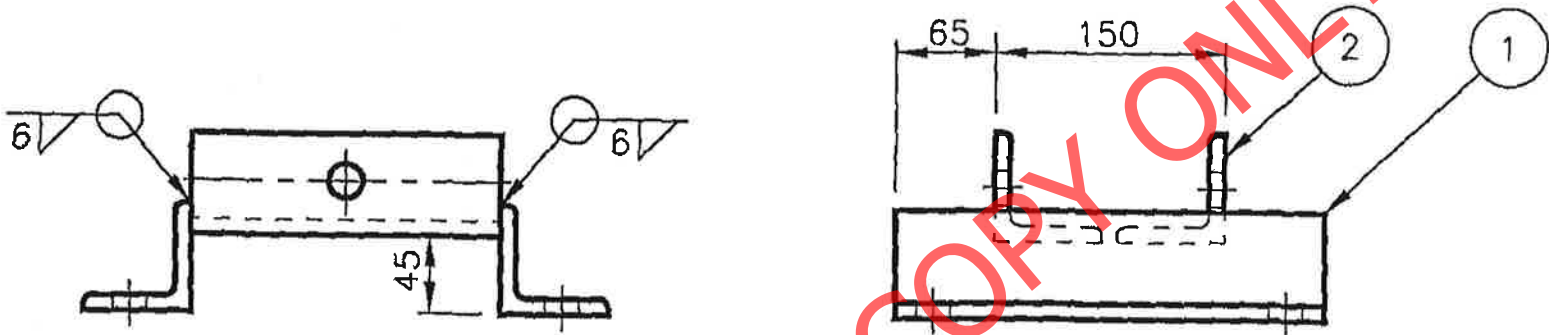

"PREVIEW COPY ONLY"

NOTE  
 WELDING TO CONFORM TO SPEC. B.S. 5135.  
 FINISH 8 3CR12  
~~ZINC COAT TO SPEC. SABS 763 FOR CONDITIONS IN SITU.~~

DIMENSIONS: mm  
 SCALE: 1:5



DO REF: Y76/43	GEN TOL: LIN± 1 ANG± -
DRN: B v RENSBURG	CKD: W R G DATE: 78-03-31
ENG: J de VILLIERS	F PIENAAR for CHIEF ENG

## ATTACHMENT FOR BOOMS

203 x 203 UNIVERSAL COLUMNS

INFRASTRUCTURE  
(ELECTRICAL)



DRG NO CEE-  
**TMFB-170**  
 SHT — OF —

ORIGINAL FRAME SIZE  
 OORSPRONKLIKE RAAMGROOTTE 267 x 180

AMENDMENTS  
 WYSIGINGS

NO.	NAME NAAM	DATE DATUM
4.	W.R. C.V.	78-03-31

REDRAWN MATERIAL  
 STANDARDISED.  
 OORBETEKEN. MATE-  
 RIAAL GESTANDAAR-  
 DISEER.  
 D.O. REF. Y77/108.  
 TK. VERW.

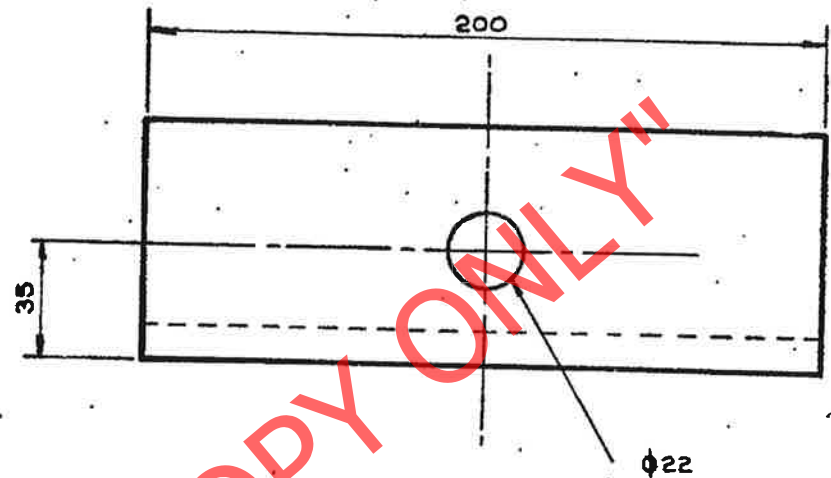

DIMENSIONS: MILLIMETRES.  
 AFMETINGS: MILLIMETER.

MATERIAL MATERIAAL  
 1) STEEL, ANGLE 70 x 70 x 10  
 STAAL, HOEK  
 STORES ITEM NO(M)11/14508  
 MAGASYNITEM  
~~ALTERNATIVE/ALTERNATIEF~~  
 2) ~~STEEL, ANGLE 63,5 x 63,5 x 9,5~~  
~~STAAL, HOEK~~  
~~STORES ITEM NO. 11/22037~~  
~~MAGASYNITEM~~  
~~SPEC. GME 9 SYM. 8~~  
~~SPEC. SYM. 3CR12~~  
~~OR COMMERCIAL GRADE~~  
~~OF HANDELSGRAAD~~

DRN. GET. FWC.	GEN. TOLERANCES: LIN ± 1	
TRCD. NGT. A. ROTHERY.	ALG. TOLERANSIES: ANGLE/HOEK —	
CKD. NGS. J.F.S.	D.O. REF. TK. VERW. —	ENG. IR. J.P. For 75
CHIEF ELECTRICAL ENGINEER, S <sup>A</sup> R ELEKTROTEGNIESE HOOFINGENIEUR, S <sup>A</sup> S JOHANNESBURG	DATE DATUM 3-6-63.	T.C. BROOK. For ns

BRACKET: BOOM ATTATCHMENT.  
 I-MASTS AND UNIVERSAL COLUMNS.  
 STEUN VIR DWARSBALKBEVESTIGING.  
 I-MASTE EN UNIVERSELE KOLOMME.

CEE - TMF - 122, 205.  
 ASSY. DRG./SAMES.-TEK.  
 DRAWING NO. CEE  
 TEKENING  
 TMHA ~ 78.

A4  
 A4

4

4

PREVIEW COPY ONLY

ITEM	DESCRIPTION	QTY	STORES ITEM NO	DRG NO CEE-	AMENDMENTS		
1	STEEL, ANGLE 70 x 70 x 6	1			NO	NAME	DATE
2	STEEL, FLAT 50 x 10 x 50	2	11/12381		1	J v DYK	2000-10-30

REDRAWN. DRG NO WAS  
CEE-TMF-209.  
DO REF T95/067

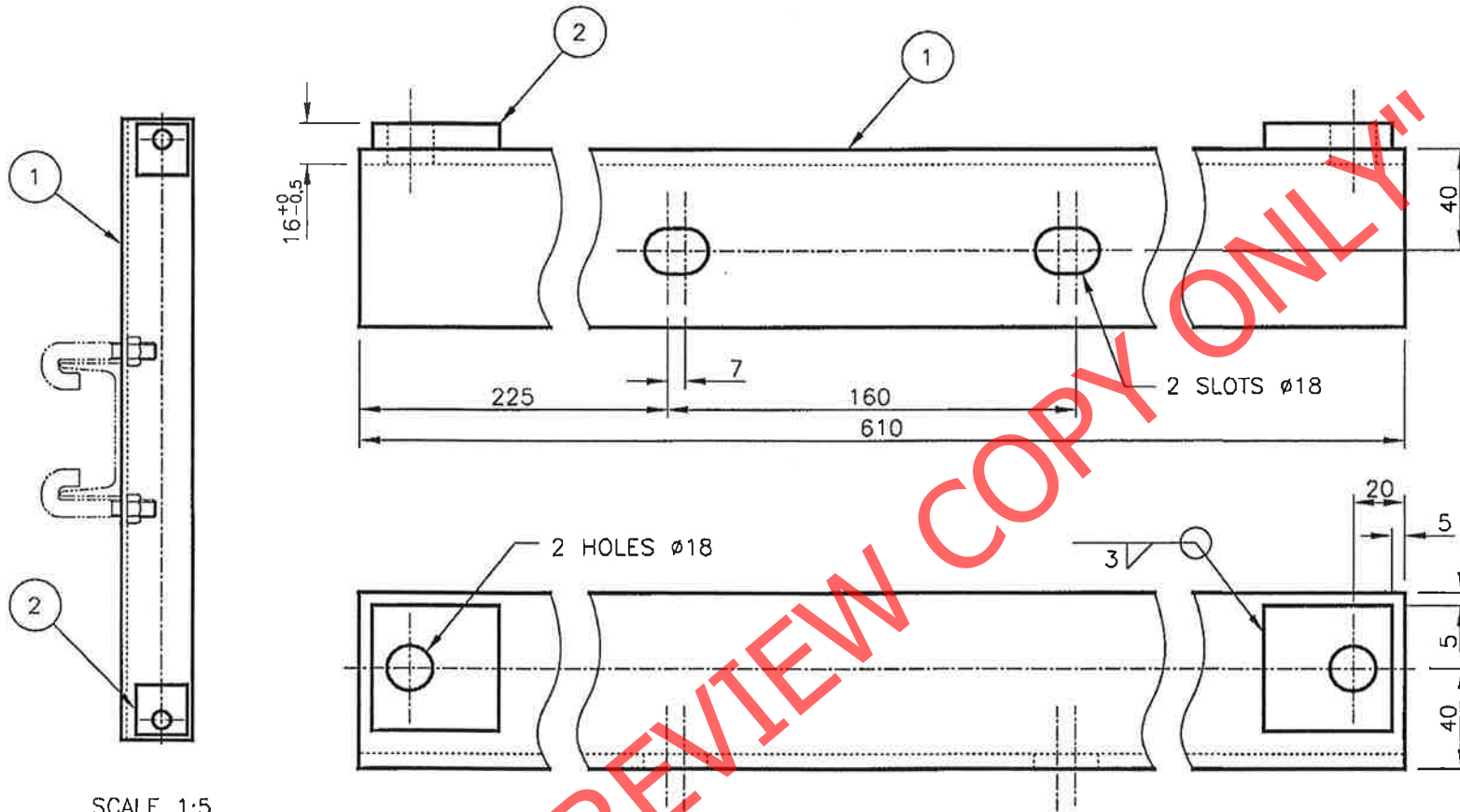

SCALE 1:5

"PREVIEW COPY ONLY"

NOTE  
WELDING TO CONFORM TO SPEC. B.S. 5135  
FINISH: 3CR12  
~~ZINC COAT TO SPEC. SABS 763 FOR CONDITIONS IN SITU~~

DIMENSIONS: mm  
SCALE: 1:2

A3

DRAWING NO CEE-  
TMFE-6

SHEET - OF -

DO REF: Y76/43	GEN TOL: LIN $\pm$ 1	ANG $\pm$ -
DRN: F HEYL	CKD: W R G	DATE: 78-03-31
ENG: J de VILLIERS	F PIENAAR	for CHIEF ENG

INFRASTRUCTURE  
(ELECTRICAL)



SUPPORT BRACKET  
STEADY ARM, VERTICAL BRACKET



ORIGINAL FRAME SIZE  
 OORSPRONKLIKE RAAMGROOTTE 267 X 180

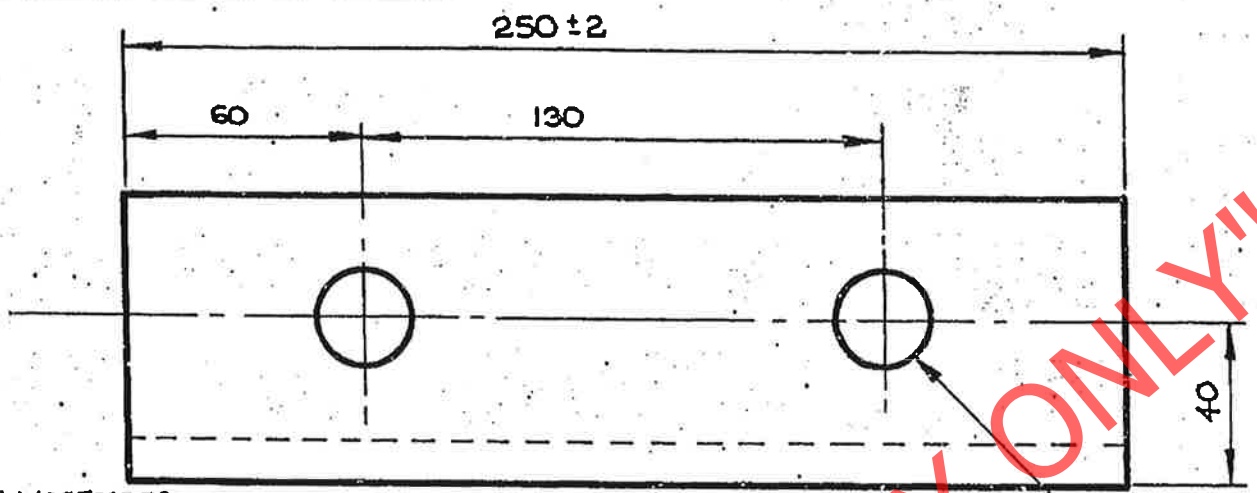

DIMENSIONS: MILLIMETRES.  
 AFMETINGS: MILLIMETER

MATERIAL - MATERIAAL

1) STEEL, ANGLE 70 X 70 X 10  
 STAAL, HOEK 70 X 70 X 10  
 STORES ITEM NO. (M) 11/14508.  
 MAGASYNITEM

ALTERNATIVE/ALTERNATIEF

2) STEEL, ANGLE 63,5 X 63,5 X 9,5  
 STAAL, HOEK 63,5 X 63,5 X 9,5  
 STORES ITEM NO. 11/22037  
 MAGASYNITEM

SPEC. CME 9 SYM. 8  
 SPES. CME 9 SIM. 8

OR COMMERCIAL GRADE  
 OF HANDELSGRAAD

ZINC COAT TO SPES. ~~SABS 763.~~  
 SINKBEDEK VOLG. SPES. ~~SABS 763.~~

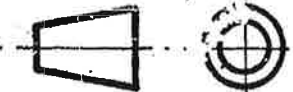
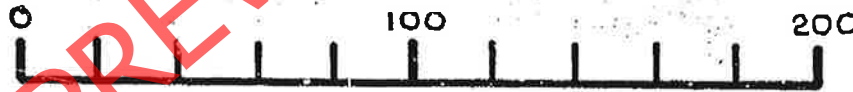

AMENDMENTS  
 WYSIGINGS

NO.	NAME NAAM	DATE DATUM
10	WRG.	78-03-31

REDRAWN, MATERIAL  
 AND DIMENSIONS  
 STANDARDISED.  
 OORGETEKEN, MATERIAAL  
 EN AFMETINGS  
 GESTANDAARDISEER.  
 D.O. REF. Y77/108.  
 TK. VERW.

11. J Jackson 78-10-31

NOTE ADDED.  
 OPM. BYGEVOEG.  
 D.O. REF. Y78/50.  
 TK-VERW.

12. B Stewart 80-12-09

ASSY. DRG. NOS  
 ADDED.  
 SAMEST. TEK. NOS  
 BYGEVOEG.  
 D.O. REF T1/80/15  
 T.K. VERW.

CEE-TMG-101 & 102  
 CEE-TMG-170 & 111  
 CEE-TMF-106  
 ASSY. DRG./SAMES-TEK.

DRAWING  
 TEKENING NO. CEE

TMHA-79

DRN. GET. K.V.V.	GEN. TOLERANCES: LIN. #1 ALG. TOLERANSIES: ANG./HOEK	
TRCD. NGT. B.V. RENSBURG	D.O. REF. TK. VERW.	ENG. IR. J.G.GN.
CKD. NGS. H.N.	DATE DATUM 18-1-65	P. MURRAY for ns
CHIEF ELECTRICAL ENGINEER. S. R. ELEKTROTEGNEISE HOOFINGENIEUR S. S.		JOHANNESBURG

CLAMPING ANGLE, VERTICAL  
 FOR STEADY ARM ATTACHMENT.  
 DOUBLE BOOM STRUCTURES.

KLAMPHOEKYSTER. VERTIKAAL  
 VIR SLINGERINGSARMHEGSTUK.  
 DUBBEL DWARSBALK STRUKTURE.

PREVIEW COPY ONLY

AMENDMENTS		
NO	NAME	DATE
1	JVT	95-09-12

DRG REVISED.  
PREVIOUS NO. WAS  
CEE-TMHA-84.  
DO REF: T95/055

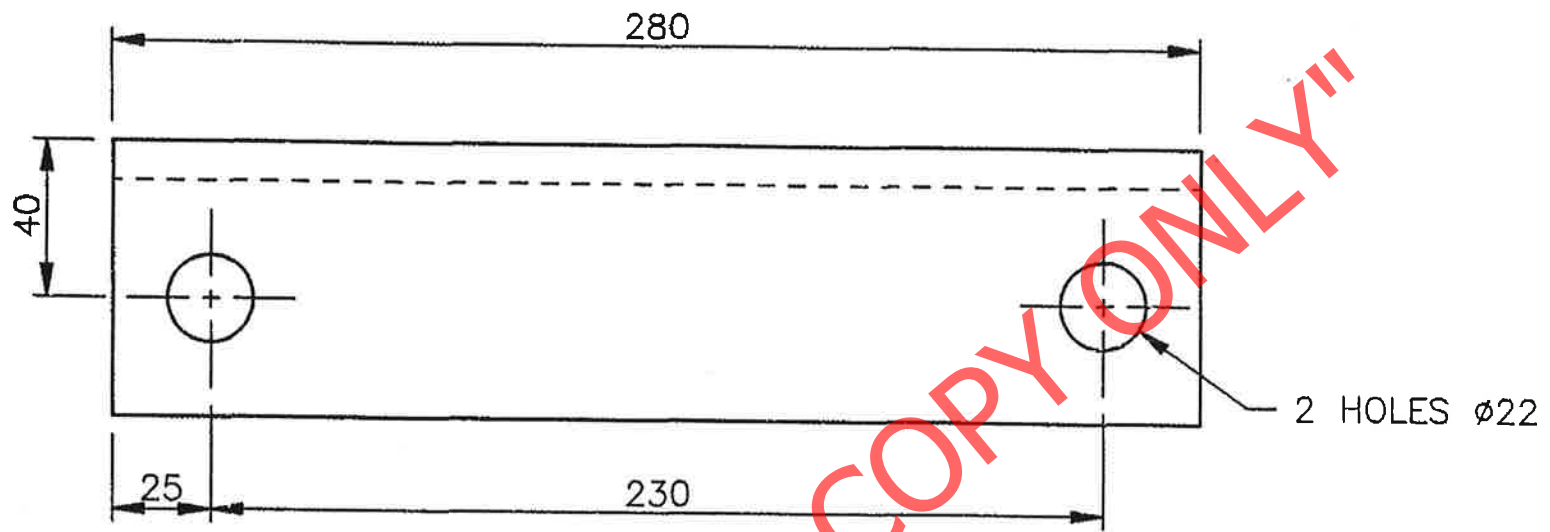

FINISH : 3CR12.  
~~ZINC COAT TO SABS 763 FOR CONDITIONS IN SITU~~  
~~WHEN NOT PART OF WELDING COMPONENT.~~

DIMENSIONS: mm  
SCALE: 1:2

MATERIAL: ITEM NO 11/14508, STEEL, ANGLE, 70 x 70 x 10 x 280 LG

DO REF: Y76/43	GEN TOL: LIN± ±1,5 ANG± -
DRN: B v RENSBURG	CKD: W.R.G. DATE: 78-03-31
ENG: J DE V.	P. PIENAAR for CHIEF ENG

**CLAMPING BRACKET**  
UNIVERSAL COLUMNS AND CONCRETE MAST

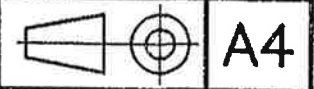

DRG NO **CEE-TMFB-138**  
SHT - OF -

INFRASTRUCTURE  
(ELECTRICAL)



T0000973